

**BuckleyBrown**  
ESTATE AGENTS

£165,000

Longhurst View, Whitwell, Worksop,

Welcome to **BuckleyBrown**, where every home is carefully presented, so you can explore with clarity and confidence.

**BuckleyBrown**  
ESTATE AGENTS

"A perfect property for those looking to settle down in a peaceful area. First impressions count and this home leaves a perfect one"

-Jasmine, Valuer



## *A spacious property in a gorgeous setting.*

*If location, space and a homely feel is what you're looking for, this is the one.*

Situated in the heart of Whitwell is this well maintained, spacious three bedroom semi detached home. With a warm atmosphere throughout, you will be sure to feel right at home. The external space will equally impress, with a meticulously maintained rear garden and a garage to the front of the home.



## Come on in...

***With neutral decor throughout, this is ideal for you to move straight in.***

As you enter you're welcomed by the hallway, leading into the bright and spacious, open plan living / dining room. A setting that is perfect for entertaining guests or simply enjoying quality time with family. Situated off here is the kitchen, complete with ample matching cabinets, with complimenting work top over. Inset sink, oven, hob and space for appliances. Into the conservatory, this is the perfect area to enjoy a good book in the summer months. To complete this floor is the family shower room.

Heading upstairs, there are three bedrooms, all with ample space and opportunity to make your own. The neutral decor allows you to add your own creative stamp and make your own private retreat to relax in after a long day. Enjoy the ease of ample storage as Bedroom One and Two both have fitted cupboards.

Outside is a space you will always want to enjoy spending time in, with a well maintained rear garden, complete with both patio and lawned areas. To the front of the home is a well looked after lawned garden, along with a handy garage!



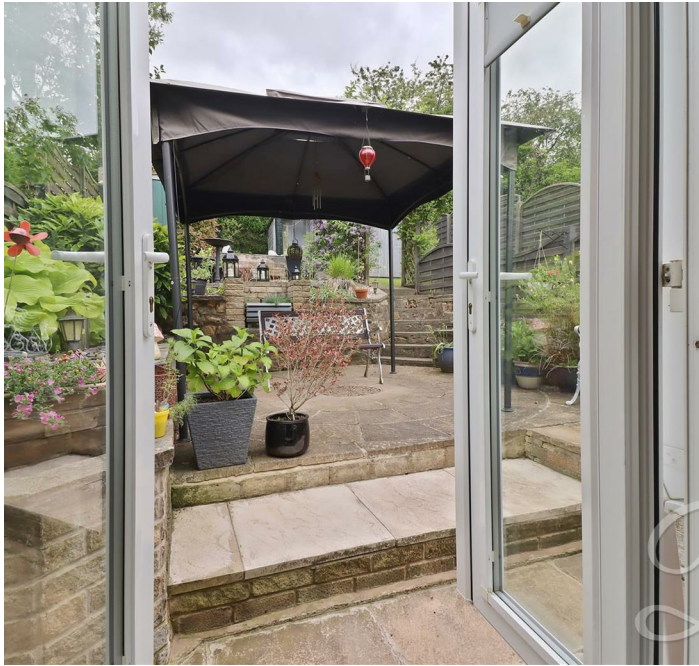

**BuckleyBrown**  
ESTATE AGENTS







## Life in Whitwell

***Located in Worksop, ensuring you get to enjoy both quiet living and easy convenience.***

Whitwell offers a quiet and peaceful area of living, while still being sat within easy reach of local towns, amenities and transport links. You will be within close proximity to the motorway making journeys to Chesterfield, Sheffield and Nottingham a breeze.

Offering local shops and amenities close by, while having the ability to travel and enjoy shopping facilitates and leisure activities in the surrounding towns and villages.

You will also benefit from being close by to Cresswell Crag, a historic site located between Cresswell and Whitwell. Offering not only a wonderful family day out full of history but site seeing, long walks and a brilliant place to spot wildlife.



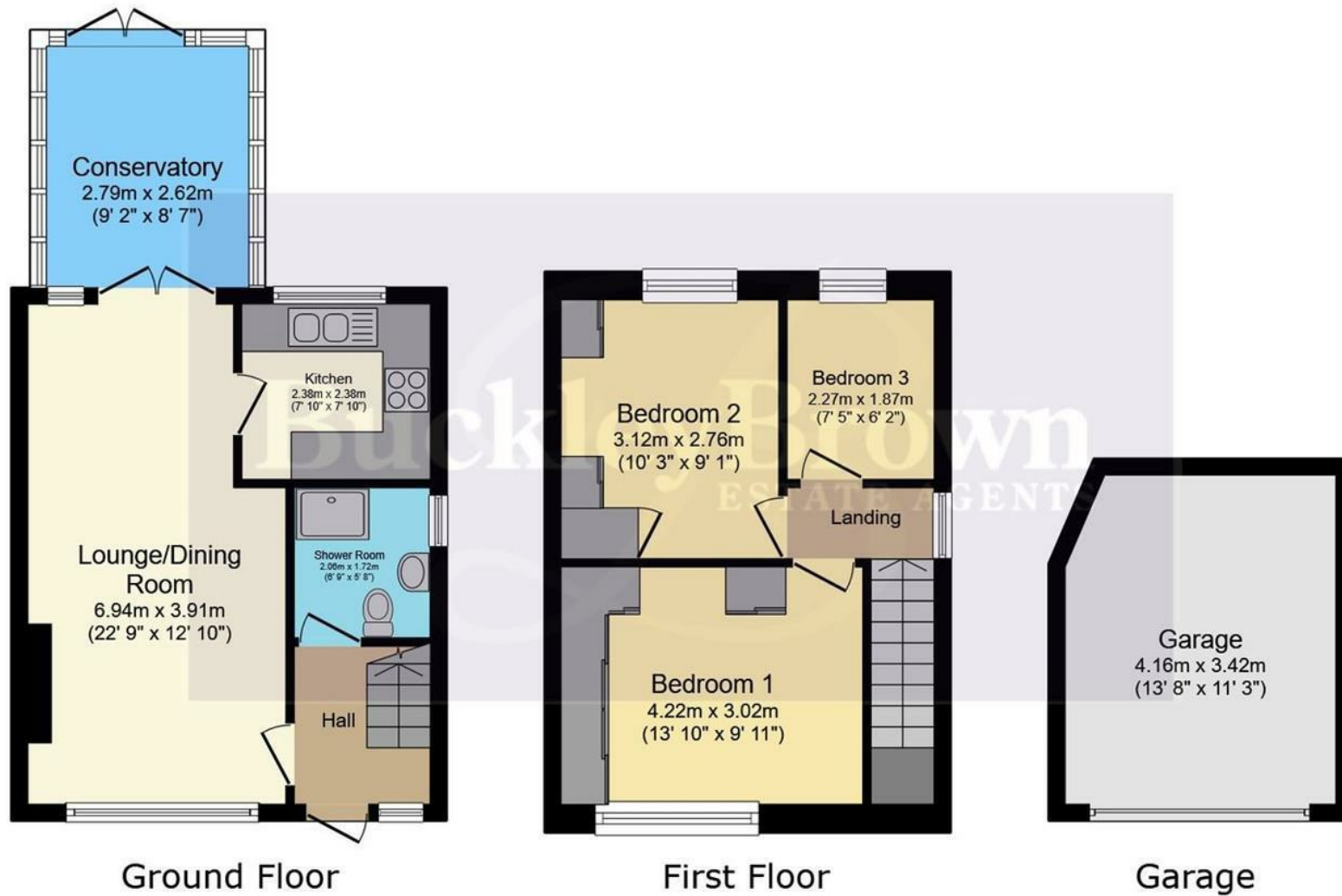

Total floor area: 84.3 sq.m. (908 sq.ft.)

This floor plan is for illustrative purposes only. It is not drawn to scale. Any measurements, floor areas (including any total floor area), openings and orientations are approximate. No details are guaranteed, they cannot be relied upon for any purpose and do not form any part of any agreement. No liability is taken for any error, omission or misstatement. A party must rely upon its own inspection(s). Powered by [www.Propertybox.io](http://www.Propertybox.io)



These particulars are intended as a guide only and do not form part of any offer or contract. All descriptions, measurements, images and plans are provided for illustration purposes and should not be relied upon as statements of fact. Prospective purchasers should satisfy themselves as to the accuracy of the information. Buckley Brown Estate Agents accept no liability for any loss arising from reliance on these details.

© Buckley Brown Estate Agents 2026. All rights reserved.

Exceptional homes deserve  
exceptional representation.

Let's Chat.

01246 605121

[bolsover@buckleybrown.co.uk](mailto:bolsover@buckleybrown.co.uk)

[buckleybrown.co.uk](https://www.buckleybrown.co.uk)

**BuckleyBrown**  
ESTATE AGENTS